

TAPPED BASE PILLOW BLOCKS

SET SCREW TYPE

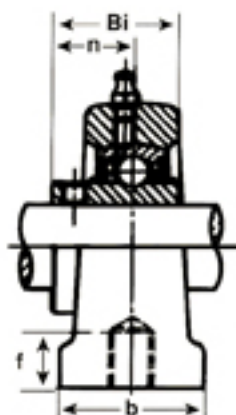

UCPA200-SERIES

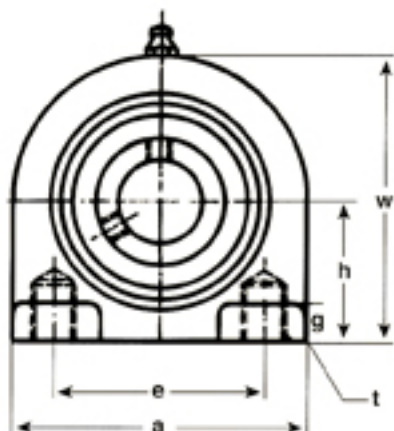
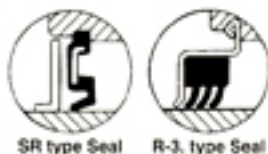

Shaft Dia. in.	SST Unit No.	Dimensions (in.)										Bearing No.	Housing No.	Weight	
		h	a	e	b	g	w	f	t	Bi	n			kg	lbs.
1/2	UCPA201-8	1-3/16	3	2-3/64	1-9/16	7/16	2-7/16	19/32	W 3/8	1.2205	0.5000	UC201-8	PA204	0.70	1.54
5/8	202-10											202-10			
3/4	204-12											204-12			
7/8	UCPA205-14	1-7/16	3-5/16	2-13/64	1-25/32	15/32	2-27/32	19/32	W 3/8	1.3386	0.5630	UC205-14	PA205	0.81	1.79
15/16	205-15											205-15			
1	205-16											205-16			
1-1/16	UCPA206-17	1-11/16	3-11/16	2-19/32	1-31/32	15/32	3-5/16	23/32	W 1/2	1.5000	0.6200	UC206-17	PA206	1.25	2.76
1-1/8	206-18											206-18			
1-3/16	206-19											206-19			
1-1/4	206-20											206-20			
1-1/4	UCPA207-20	1-7/8	4-11/32	3-5/32	2-5/32	1/2	3-3/4	25/32	W 1/2	1.6890	0.6890	UC207-20	PA207	1.70	3.75
1-5/16	207-21											207-21			
1-3/8	207-22											207-22			
1-7/16	207-23											207-23			
1-1/2	UCPA208-24	1-15/16	4-9/16	3-5/16	2-9/32	1/2	3-15/16	25/32	W 1/2	1.9370	0.7480	UC208-24	PA208	2.00	4.41
1-9/16	208-25											208-25			
1-5/8	UCPA209-26	2-9/64	4-23/32	3-35/64	2-3/8	1/2	4-1/4	1	W 1/2	1.9370	0.7480	UC209-26	PA209	2.30	5.07
1-11/16	209-27											209-27			
1-3/4	209-28											209-28			
1-7/8	UCPA210-30	2-1/4	5-1/8	3-45/64	2-17/32	9/16	4-9/16	1	W 5/8	2.0315	0.7480	UC210-30	PA210	2.90	6.39
1-15/16	210-31											210-31			