

TAKE-UP UNITS

WIDE SLOT—ECCENTRIC LOCKING COLLAR TYPE

HCST200-SERIES

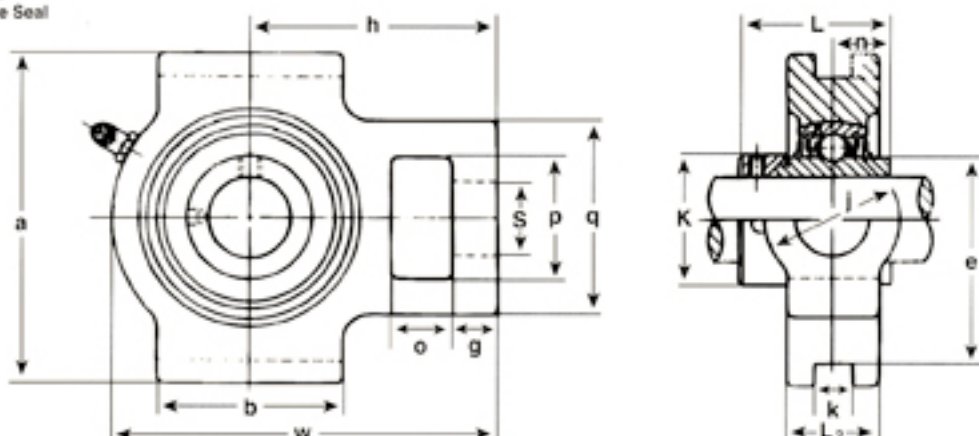
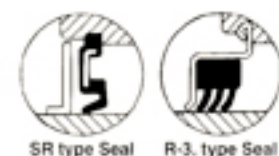

Shaft Dia. mm	in.	SST Unit No.	Dimensions (in.)															Bearing No.	Housing No.	Weight		
			c	g	q	p	s	b	k	e	a	w	j	L ₂	h	L	n			K	kg	lbs.
20	3/4	HCST204-12	5/8	3/8	2	1-1/4	3/4	2	17/32	3	3-1/2	3-11/16	1-1/4	15/16	2-3/8	1.720	0.673	1-1/4	HC204-12	ST204	0.84	1.85
		HCST204																	HC204			
25	7/8	HCST205-14	5/8	3/8	2	1-1/4	7/8	2	17/32	3	3-1/2	3-13/16	1-1/4	15/16	2-7/16	1.748	0.688	1-1/2	HC205-14	ST205	0.88	1.94
	15/16	205-15																	HC205-15			
	1	205-16																	HC205-16			
		HCST205																	HC205			
30	1-1/16	HCST206-17	5/8	3/8	2-3/16	1-7/16	7/8	2-1/4	17/32	3-1/2	4	4-7/16	1-7/16	15/16	2-3/4	1.905	0.720	1-3/4	HC206-17	ST206	1.33	2.93
	1-1/8	206-18																	HC206-18			
	1-3/16	206-19																	HC206-19			
	1-1/4	206-20																	HC206-20			
		HCST206																	HC206			
35	1-1/4	HCST207-20	5/8	1/2	2-1/2	1-7/16	7/8	2-1/2	17/32	3-1/2	4	5-1/16	1-7/16	1-3/16	3-1/16	2.016	0.742	2-3/16	HC207-20	ST207	1.76	3.88
	1-5/16	207-21																	HC207-21			
	1-3/8	207-22																	HC207-22			
	1-7/16	207-23																	HC207-23			
		HCST207																	HC207			
40	1-1/2	HCST208-24	3/4	5/8	3-1/4	1-15/16	1-1/8	3-1/4	11/16	4	4-1/2	5-11/16	1-15/16	1-3/8	3-1/2	2.220	0.844	2-3/8	HC208-24	ST208	2.55	5.62
	1-9/16	208-25																	HC208-25			
		HCST208																	HC208			
45	1-5/8	HCST209-26	3/4	5/8	3-1/4	1-15/16	1-1/8	3-1/4	11/16	4	4-5/8	5-11/16	1-15/16	1-3/8	3-7/16	2.220	0.844	2-1/2	HC209-26	ST209	2.65	5.84
	1-11/16	209-27																	HC209-27			
	1-3/4	209-28																	HC209-28			
		HCST209																	HC209			
50	1-7/8	HCST210-30	3/4	5/8	3-1/4	1-15/16	1-1/8	3-3/8	11/16	4	4-5/8	5-7/8	1-15/16	1-3/8	3-9/16	2.468	0.969	2-3/4	HC210-30	ST210	2.95	6.50
	1-15/16	210-31																	HC210-31			
		HCST210																	HC210			
55	2	HCST211-32	1	3/4	4	2-1/2	1-3/8	3-3/4	1-1/16	5-1/8	5-3/4	6-3/4	2-1/2	1-5/8	4-13/16	2.814	1.049	3	HC211-32	ST211	4.39	9.68
	2-1/8	211-34																	HC211-34			
	2-3/16	211-35																	HC211-35			
		HCST211																	HC211			
60	2-1/4	HCST212-36	1-1/4	3/4	4	2-1/2	1-3/8	4	1-1/16	5-1/8	5-3/4	7-5/8	2-1/2	1-13/16	4-11/16	3.062	1.219	3-5/16	HC212-36	ST212	5.55	12.24
	2-3/8	212-38																	HC212-38			
	2-7/16	212-39																	HC212-39			
		HCST212																	HC212			

Note: Narrow slot take-up housings can be tooled (e.g., HCSTN 205-16).